

1700, Setlakwe Street
Thefford Mines (QC) G6G 8B2
CANADA
www.technometalpost.com

CONFIDENTIAL
THE INFORMATIONS CONTAINED
IN THIS DRAWING IS THE SOLE
PROPERTY OF TECHNO PIEUX INC.
ANY REPRODUCTION IN PART OR
AS A WHOLE WITHOUT THE WRITTEN
PERMISSION OF TECHNO METAL POST INC.
IS PROHIBITED

REVISIONS

DATE	DESCRIPTION	REV.
26/06/2013	Revised load capacity.	1

Client :

Client address :

Project :

Drawing : **Techno Metal Post
Model P6
(Deep foundation)**

Approved by :

Date : 2011-10-31
Scale : N/A

Drawing no: P6-R1-A
Page number : SHEET 1 OF 1

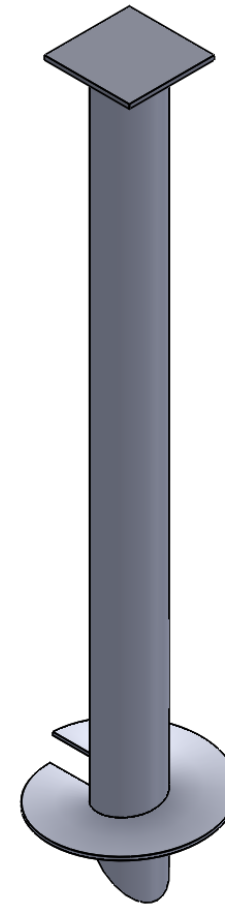

Supporting plate
Standard : CSA G40.21 - Steel

Steel shaft
Model P6 : 6.625" x 0.280" [168.3mm x 7.1mm]
Standard : ASTM A500 grade C - Circular steel section

1/2" [12.7"] Thick factory-welded helix
Standard : CSA G40.21 - Steel

Actual pile length to be determined by field conditions and desired loading capacity.

12" to 24"
[305 to 610mm]
Helix diameter varies according to soil conditions and desired loading capacity.

Load Capacity							
Maximum compressive bearing capacity ^{1,3}				Lateral bearing capacity ^{2,4}		Factored bending resistance	
SLS		ULS		SLS		ULS	
(lbs)	(kN)	(lbs)	(kN)	(lbs)	(kN)	(lbs.ft)	(kN.m)
50,625	225.2	70,875	315.3	6,750	30.0	33,876	45.9

NOTES:

- The maximum tensile load capacity can be obtained, conservatively, by halving the values of the bearing capacity in compression shown in the selection table.
- The lateral capacity depends on the density of soil (to validate consult technical department of Techno Metal Post.)
- When the pile is laterally unsupported (soil very loose / soft, liquefiable soils, water and air), the structural strength of the pile must be approved by the technical department of Techno Metal Post.
- The values of lateral capacity are average values and can be modified, more or less, depending on the characteristics of the existing soil.
- If required, piles may be field welded with extensions to achieve greater loading capacities in poor soil conditions.
- If required, the helical pile and the supporting plate can be galvanized in compliance with standard CAN / CSA G-164-M92 610g / m²